

ASTM CATEGORY 5 : GRAVITY RIDING FOCUSED ON THE DESCENT
 For a longer longevity of the wheel, Mavic recommends that the total weight supported by the wheels doesn't exceed 150kg, bike included
 Recommended tyre sizes: 65mm to 81mm (2.5" to 3.2")

REFERENCES WHEELS

F91581	E-Deemax S 35 27,5 Ft Bst	F91591	E-Deemax S 35 27,5DCL Ft Bst
--------	---------------------------	--------	------------------------------

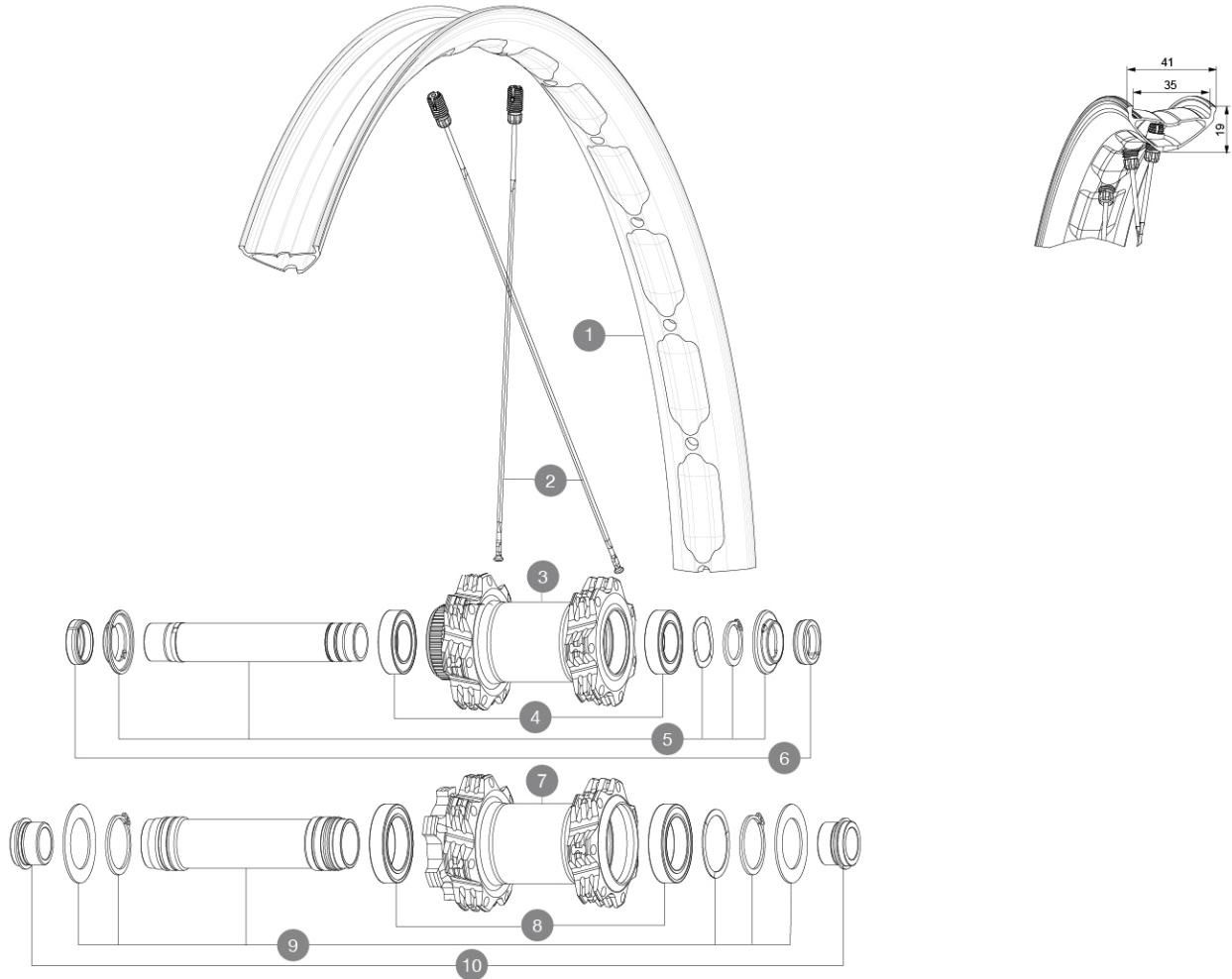

RIMS



&NBSP::

1	V3766515	Kit Front/Rear rim eDeemax S 27,5
---	----------	-----------------------------------

SPOKES

2	V2388801	Kit 14Ft eDeemaxS 27,5" btd spk287 M7/7
---	----------	---

HUB SHELLS

3	N/A	HUB BODY
4	V2500901	KIT BEARINGS 18x30x7 + WAVED WASHER + CLIP
5	V2375601	Kit 110mm axle QRM auto MTB from 2019 DCL
6	V2372501	KIT FT MTB FORKREST FROM 2019
7	N/A	HUB BODY
8	M40179	FRONT HUB BEARING KIT 20mm AXLE
9	V2373701	KIT 20x110mm BOOST AXLE QRM AUTO MTB > 2019
10	12982801	ADAPTER Ft 20 to 15mm

MAVIC E-Deemax S35 27

2021
FRONT

DELIVERED WITH

UST valve and accessories (129 838 01)	
Multifonction adjustment wrench (delivered with rear wheel) (325 423 01)	
2 replacement spokes with each wheel	
Fore adjustment wrench	

COMPATIBILITY

Front axle: 15x110 Boost, convertible to 20x110 Boost thru axle with adapters	
Freewheel: Shimano HG9, XD or Micro Spline	
Rear axle: 12x148 Boost thru axle	

Specifications

RIMS

- **Material** : Maxtal
 - **Material** : S6000 Aluminum
 - **Weight reduction** : ISM
- E-Bike specific rim profile
- **Tire** : UST Tubeless and tubetype
 - **Internal width** : 35 mm
 - **ETRTO size 27.5"** : 584x35TC
- Black Shield treatment (protects your rim against impacts and scratches)
Pinch Flat Protection sidewall (minimizes the risk of tire cuts and punctures)
Asymmetrical rim design
Fore
SUP

SPOKES

- **Material** : steel
- **Shape** : straight pull, flat, double butted
- **Nipples** : Fore integrated aluminum
- **Count** : 28 front and rear
- **Lacing** : front and rear crossed 3, contactless

WHEEL HUB

Hub available with 6-bolt or center lock (R) brake rotors

- **Axles** : Front 15X110 Boost ; Rear 12X148 Boost

Instant Drive 360
QRM Auto

VERSIONS

- **Disc standard** : 6 Bolts or Center Lock (R)
- **Hub width** : Boost only (front 110, rear 148)
- **Freewheel** : SRAM XD, Shimano HG9, Shimano Micro-Spline

WHEEL WEIGHTS

940